

## Please refer to the following examples of electrical receptables on emergency power:

The most obvious electrical receptacles on emergency power will be a **red** outlet.

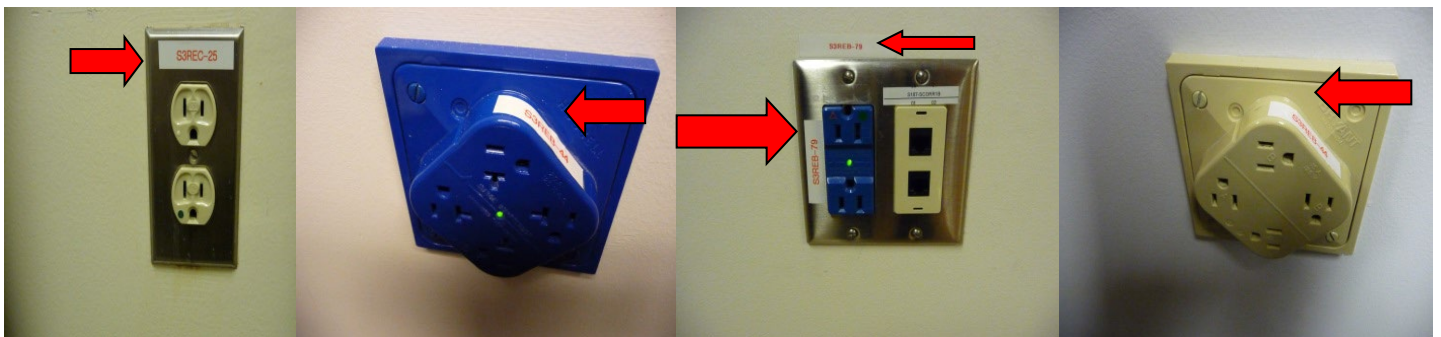

Other receptacles that are not red but *are* on emergency power will have a sticker on them with **red numbers** and/or **lettering**.



**Contact for more information:** Michael Emmott, UBC Hospital Facilities, Maintenance and Operations (FMO) at [michael.emmott@vch.ca](mailto:michael.emmott@vch.ca) 604.802.1918.